

3		2					1		
MACHINING DEVIATIONS FOR LINEAR DIMENSIONS	RANGE	0 - 6	6 - 30	30 - 120	120 - 315	315-1000	1000-2000	2000-4000	ABOVE 4000
	TOLERANCE	±0.1	±0.2	±0.3	±0.5	±0.8	±1.2	±2	±3
FOR DIMENSIONAL TOLERANCES OF SHEET METAL PARTS AND WELDED STRUCTURES, REFER STD. RD-227									
UNSPECIFIED TOLERANCE FOR LINEAR AND ANGULAR DIMENSIONS REF. IS 2002 (PT-1) (MEDIUM)							QUALITY OF WELD JOINTS REF. RD 230 MEDIUM		
VALUES OF SURFACE TEXTURE SHALL BE AS PER COMPANY STD DS-402/C.							WELDING SHALL BE CARRIED OUT AS PER IS: 9595-96		
							STATUS:		PROTO

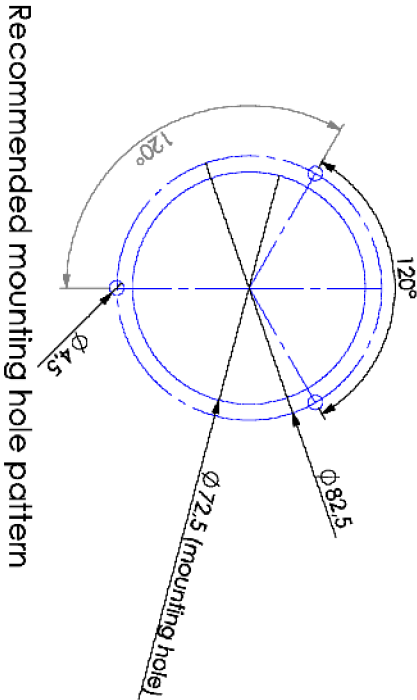

Recommended mounting hole pattern

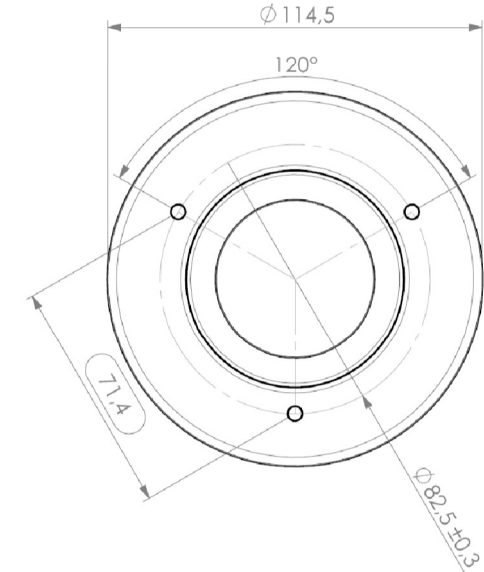
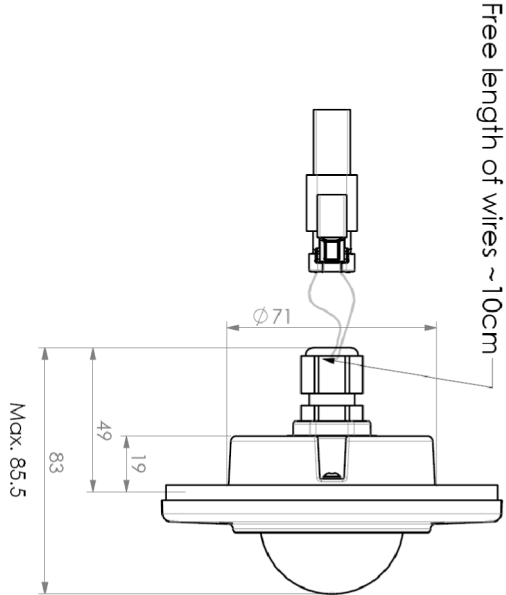
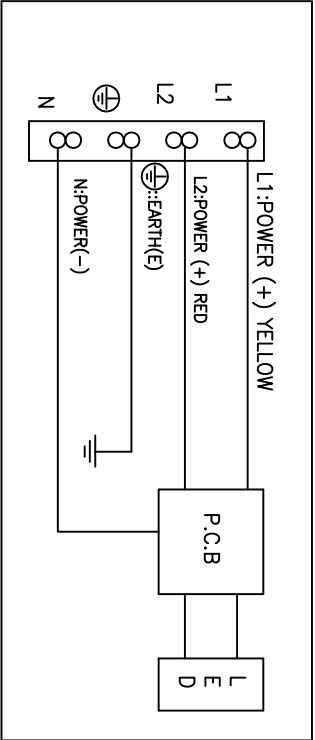

WIRING DIAGRAM

DETAIL NO.12
(SCALE 1:2)

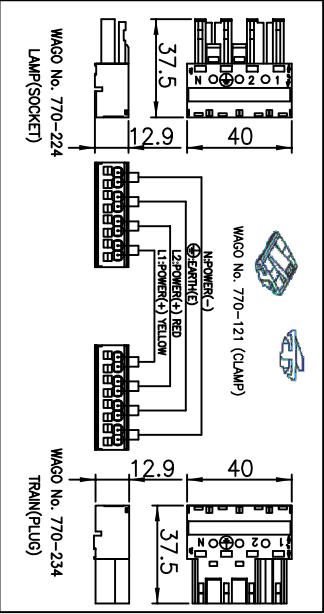

NOTE: 1. ALL MATING CONNECTORS FOR CAR BODY SIDE WIRING ALONG WITH PINS/SOCKETS TO BE SUPPLIED

2. OPERATING VOLTAGE: 24V DC.
3. PTS GR/TD/4263 TO BE FOLLOWED.
4. INGRESS PROTECTION LEVEL SHOULD BE ATLEAST IP65.
5. FIRE PERFORMANCE : EN45545 HL3
6. OVERALL DIMENSION, MOUNTING, AESTHETICS SHALL BE SAME AS THIS DRAWING.
7. LIGHT COLOR(DUAL): AMBER /YELLOW & RED
8. THIS IS ONLY PRELIMINARY DRAWING, ACTUAL DRAWING MAY VARY AT DESIGN
9. SILICON FOAM RUBBER (COMPRESSION) PACKING AS A SINGLE PIECE SHALL BE PROVIDED AT
10. THE MOUNTING HOLE AREA (REAR SIDE OF THE LIGHT) IN GLUED CONDITION.
11. DURING DOOR OPENING & CLOSING CONTINUOUS PULSE SIGNAL WILL BE PROVIDED FROM DOOR
12. CONTROL UNIT FOR FLASHING OF LIGHT AT L1 & ONCE FULLY OPEN CONTINUOUS SIGNAL WILL BE
13. PROVIDED AT L1.

GRADE No.	N12	N11	N10	N9	N8	N7	N6	N5	N4	N3	N2	N1
VALUE	50	25	12.5	6.3	3.2	1.6	0.8	0.4	0.2	0.1	0.05	0.025
SYMBOL	✓	✓	✓	✓	✓	✓	✓	✓	✓	✓	✓	✓

COPY RIGHT & CONFIDENTIAL	THIS DOCUMENT IS THE EXCLUSIVE PROPERTY OF BEML & CONTAINS CONFIDENTIAL INFORMATION. THIS DOCUMENT OR ITS CONTENTS SHALL NOT BE USED, REPRODUCED OR DISCLOSED IN WHOLE OR IN PART, WITHOUT PRIOR WRITTEN PERMISSION OF BEML. THIS DOCUMENT & ALL ITS COPIES SHALL BE RETURNED TO BEML ON DEMAND. DRAWING RELEASED FROM PLM, PHYSICAL SIGNATURE NOT REQUIRED.											
---------------------------	--------------------------------------------------------------------------------------------------------------------------------------------------------------------------------------------------------------------------------------------------------------------------------------------------------------------------------------------------------------	--	--	--	--	--	--	--	--	--	--	--

SURFACE	ROUGHNESS	8	7	6	5	4	3	2	1	A2
---------	-----------	---	---	---	---	---	---	---	---	----

▽					PRODUCT		MUMBAI METRO CARS L2 & L7
					REF DRG		
▽					MATERIAL		
					HEAT TREAT		
					SURFACE TREAT		
					TITLE		
▽	UPDATED & REVISED		03.10.2019	DIVYA S	DOOR INDICATION LAMP (OUTSIDE)-LED (DUAL COLOR-YELLOW & RED)		
▽	1	UPDATED CONNECTOR DRAWING & VOLTAGE LEVEL WITH LED COLOR INDICATOR	26.09.2019	DIVYA S	LIXON T		
AL1 NO.	ECN NO/CHANGES	DATE	BY	CHKD	APPD	BESL BEML LIMITED	
						DRG No. 525-21029	
▽	2					SCALE 1 OF 1	
▽	2					SHEET 0	
▽	2					Wt (kg) 0	
▽	2					ALT	